

TALAS

Paardenkerkhofstraat 56 B-2800 Mechelen
 Tel. +32(0)15.61.60.07 Fax. +32(0)15.61.75.27
 Email. info@talas.be www.talas.be

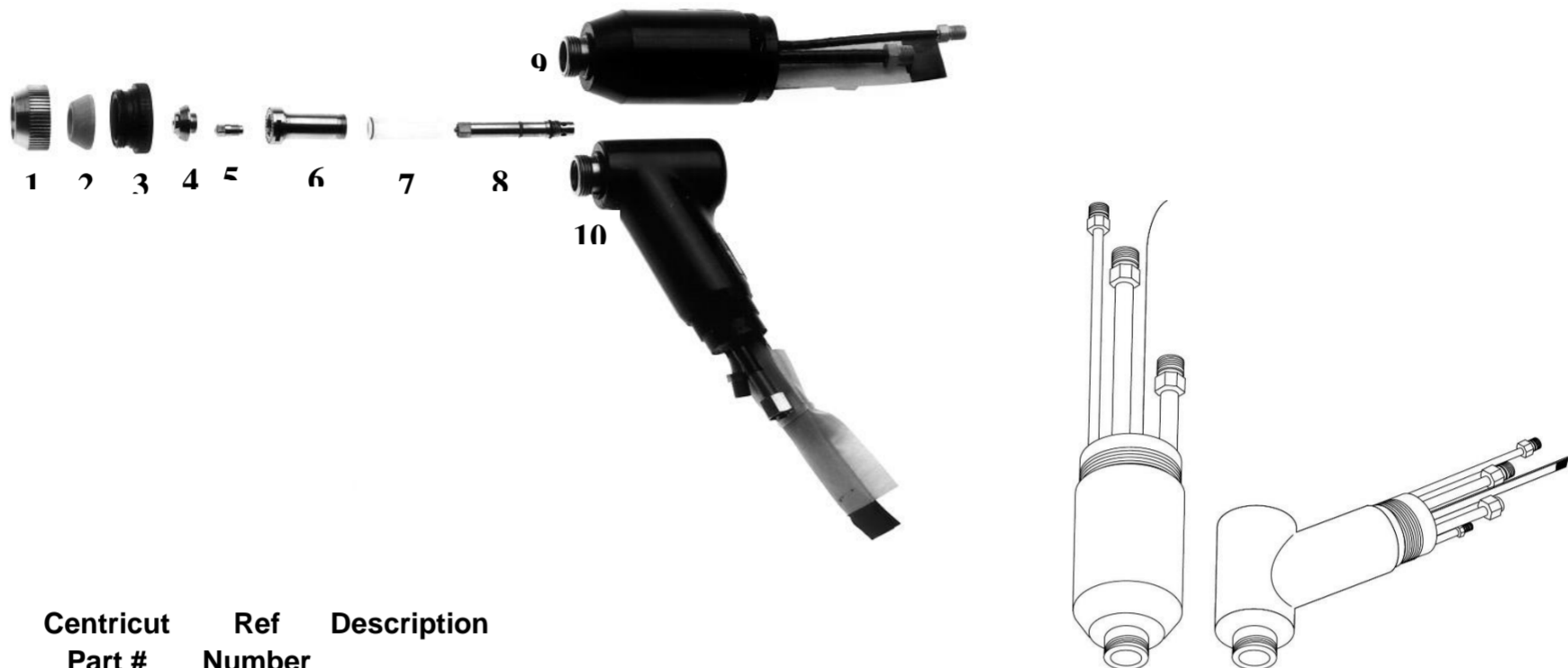

PCH/M-6B (PAK 44, 45)



| Item No. | Pkg Qty | Centricut Part # | Ref Number | Description |
|----------|---------|------------------|------------|--|
| 1 | 1 | C09-515 | 8-6515 | End Cap |
| 2 | 5 | C09-514 | 8-6514 | End Piece |
| 3 | 1 | C09-581 | 8-6581 | Outer Insulator |
| | 5 | C09-512 | 8-6512 | Gasket |
| 4 | 10 | C09-580 | 8-6580 | Tip, .067, 100 Amp |
| | 10 | C09-648 | 8-6648 | Tip, .076, 150 Amp |
| | 10 | C09-575 | 8-6575 | Tip, .093, 200 Amp |
| | 10 | C09-582 | 8-6582 | Tip, .113, 300 Amp |
| | 10 | C09-572 | 8-6572 | Tip, .125, 400 Amp |
| 5 | 10 | C09-578 | 8-6578 | Electrode, General Purpose |
| | 10 | C09-586 | 8-6586 | Electrode, Lo-Amp |
| 6 | 1 | C09-571 | 8-6571 | Liner, Includes O-Rings C09-531, C09-956 |
| 7 | 1 | C09-569 | 8-6569 | Gas Distributor |
| | 1 | C09-587 | 8-6587 | Gas Distributor, Rev Swirl |
| 8 | 1 | C09-615 | 8-6615 | Electrode Holder |
| 9 | 1 | C09-577 | 8-6577 | PCM-6B Torch Body |
| | 1 | C09-584 | 8-6584 | PCH-6B Torch Body, 90° |
| 10 | 1 | T09-583 | 8-6583 | PCH-6B Torch Body, 70° |
| | 1 | C09-614 | 8-6614 | Heat Shield, PCM-6B |
| | 1 | HYP-7055 | 8-4025 | O-Ring Lube |

€ 2,50 5pcs

Reference to the above-named machines, torches, and reference numbers are for convenience only. All products with a "C" in the part number are manufactured by or for Centricut, LLC. The use of other prefixes indicate parts manufactured by the above-named OEM, which are simply being resold by Centricut, LLC., and will be supplied in OEM packaging.