

TALAS

Paardenkerkhofstraat 56 B-2800 Mechelen
 Tel. +32(0)15.61.60.07 Fax. +32(0)15.61.75.27
 Email. info@talas.be www.talas.be

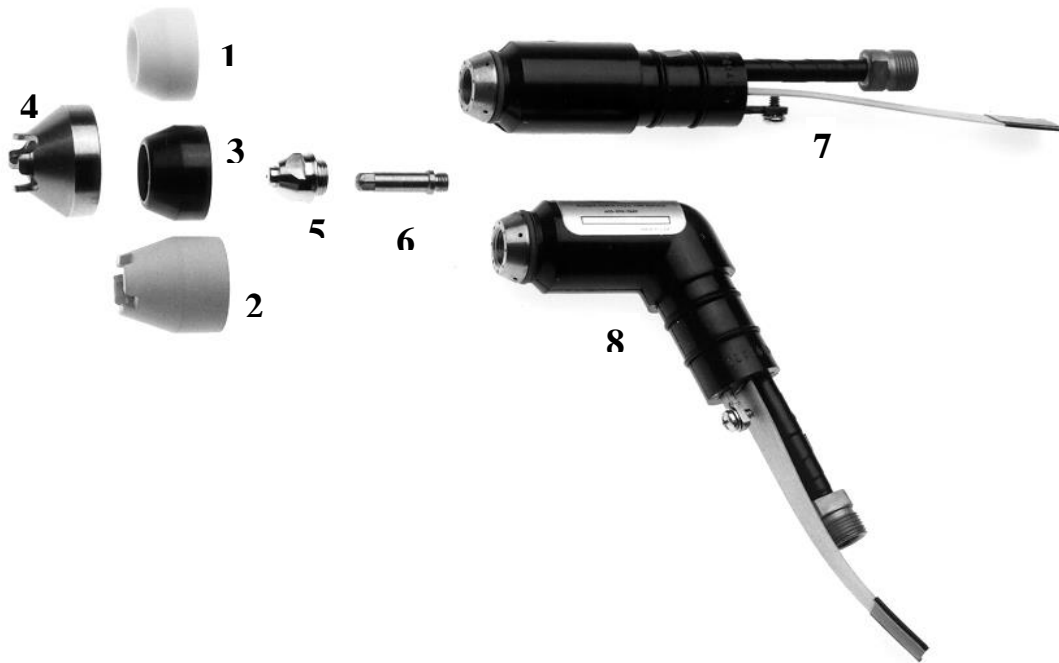

PCH/M-51 (Pak 3XR, 5XR, 5XT, 6XR, 625XR, 750XR, Dynapak 4Xi, 6Xi)



Item No.	Pkg Qty	Centricut Part #	Ref Number	Description	
1	5	C06-630	9-5630	Shield Cup, Ceramic	
3	5	C06-526	8-5526	Crown Cup, Ceramic	
2	5	C06-781	8-2159	Shield Cup, Shatter Proof	
4	1	T06-779	9-5779	Crown Cup, Copper Long, use w/ C06-781	
	1	C07-780	9-5780	Crown Cup, Copper Short, use w/ C07-781	
5	10	C06-631	9-5631	Tip, Chrome, .043, 55 Amp	€ 1,17 10pcs
	10	C06-031	N/A	Tip, Copper, .043, 55 Amp	€ 1,19 10pcs
	5	C06-718	9-5718	Tip, Chrome, .038, 35 Amp	
	5	C06-321	8-3321	Tip, Chrome, .047, 70 Amp	
	5	C06-724	9-5724	Tip, Chrome, Gouging, .078	
6	10	C06-633	9-5633	Electrode, Chrome	
	10	C06-033	N/A	Electrode, Copper	
7	1	C06-634	9-5634	PCM-51 Torch Body	
8	1	C06-635	9-5635	PCH-51 Torch Body, 70°	
	1	C06-901	N/A	Bottoming Tap, 7/16 in.-28, Tip	
	1	C06-902	N/A	Bottoming Tap, 1/4 in.-28, Electrode	
	5	C06-525	8-5525	O-Ring	
	1	HYP-7055	8-4025	O-Ring Lube	
	5	C08-010	N/A	Ball Casters	

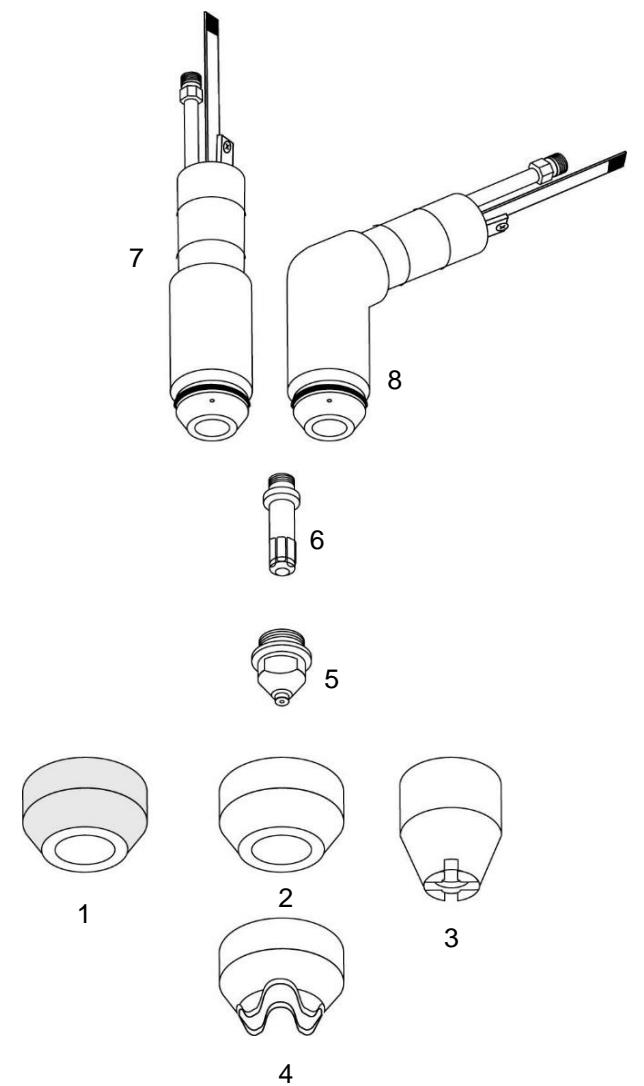

Reference to the above-named machines, torches, and reference numbers are for convenience only. All products with a "C" in the part number are manufactured by or for Centricut, LLC. The use of other prefixes indicate parts manufactured by the above-named OEM, which are simply being resold by Centricut, LLC., and will be supplied in OEM packaging.